



THE UNIVERSITY OF
MELBOURNE

Appointment of

Professor in Criminology

Faculty of Arts, School of Social and Political Sciences



Contents

1. The University of Melbourne
2. The Melbourne Vision
3. Faculty of Arts
4. Position Description & Selection Criteria
5. People & Benefits
6. Living & Working in Melbourne
7. Further Information
8. How to Apply



The University of Melbourne

Consistently ranked as Australia's best university, Melbourne enjoys an outstanding reputation as one of the world's leading comprehensive research-intensive universities.

Ranked number 32 in the latest Times Higher Education World University Rankings*, Melbourne competes on an international stage with the best institutions globally and has an international outlook and reach to match.

With a rich history stretching over 160 years, the University of Melbourne also occupies a special place in the heart of the city. Since its founding in 1853, the University has been a public-spirited institution committed to making distinctive contributions to

intellectual, cultural, social and economic life in the region and beyond. These values underpin the University's entire academic mission and shape operating practices, preparing engaged graduates and steering research that advances the world.

With a wide range of disciplines, the University of Melbourne currently educates over 50,000+ students from over 130 countries. The University comprises ten Academic Divisions providing learning that stimulates, challenges and fulfils the potential of excellent students from around the world, leading to personal development, meaningful careers and profound contributions to society.

The alumni network is significant and truly international, with representation from 160 countries. This international community includes former Prime Ministers, Governors General, and Nobel Laureates, and is a testament to the world-class education the University of Melbourne delivers.

The University employs over 8,000+ staff including many renowned researchers and industry leaders who are internationally recognised. Some of our scholars and high-achieving staff include Nobel Prize Laureate Professor Peter Doherty, who co-discovered how the immune system recognises virus infected cells; internationally recognised chemist, Professor Andrew Holmes, President of the Australian Academy of Science, who received the 2012 Royal Medal for his groundbreaking research in polymer chemistry; and Paediatric neurologist, Professor Ingrid Scheffer, who received the 2012 Asia-Pacific L'Oréal-UNESCO Women in Science award for her pioneering research into the causes of epilepsy.

The University of Melbourne operates an annual budget exceeding \$2 billion, with income from research grants, student fees, government grants, commercial operations, executive education, investment and philanthropy. The increased demand for teaching programs, and the University's focus on sustainability and resilience, have allowed savings to be reinvested into strategic teaching and research-related initiatives.

*Times Higher Education World University Rankings 2019

The Melbourne Vision

The University of Melbourne is committed to being one of the finest universities in the world, contributing to society in ways that enrich and transform our lives. We will know we have been successful in our aspirations if, by 2020, the University of Melbourne is:



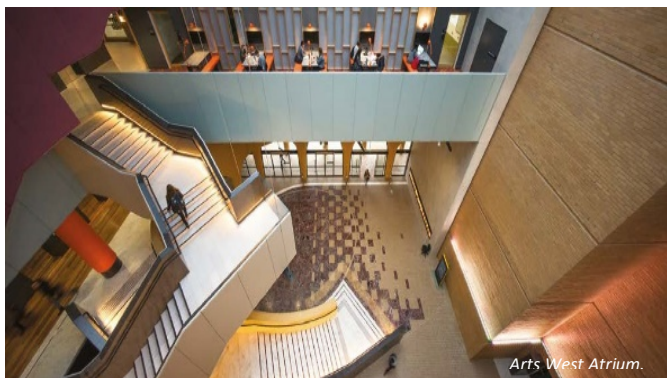

The Faculty of Arts

The Faculty of Arts at the University of Melbourne is widely recognised as Australia's premier Arts Faculty

Arts at Melbourne is home to the University's first degree, the Bachelor of Arts. The Faculty brings together leading local and international scholars, and industry partners, across 40 disciplines of study in the humanities, social sciences and languages. Our academic staff are of international standing and committed to excellence in teaching and research. The Faculty currently hosts two ARC Centres of Excellence and a series of research centres, units and networks.

Our Bachelor of Arts is one of the most sought-after degrees in Australia, consistently attracting outstanding students from around the country, and internationally. Our teaching programs encourage critical inquiry, creativity, global perspectives and the questioning of ideas. In 2016, the Faculty opened Arts West – an award-winning building in the heart of the historic campus and a new home for the Bachelor of Arts. Arts West supports active and informal learning through object-based learning laboratories and purpose-built teaching spaces which has transformed teaching and learning in the humanities and social sciences, setting a new benchmark in the Asia region.

Our Graduate School of Humanities and Social Sciences offers 19 professionally oriented Masters programs such as Arts and Cultural Management, Applied Linguistics, Global Media Communication, International Relations and Public Policy and Management. The Graduate School also houses our outstanding PhD program.

Over its 150-year history, the Faculty has produced leaders in a wide range of fields, including government, business, creative industries and media, community and not-for-profit organisations. The Faculty maintains

strong strategic relationships with leading international universities through joint teaching collaborations, research projects and student exchange programs. Partnerships with government, not-for-profit and private organisations facilitate work integrated learning opportunities for our students and research collaboration with our researchers. The Faculty has an active and vibrant outreach program, promoting lifelong learning in the humanities, languages and social sciences.

Our community includes over 450 academic and professional staff, 10,000 students across undergraduate, graduate coursework and research higher degree programs, and a strong and active alumni population of over 70,000 worldwide.

Alongside the Graduate School of Humanities and Social Sciences, the Faculty consists of five interdisciplinary Schools:

Asia Institute—the University's key centre for study in Asian languages and cultures, with programs including Arabic, Chinese, Indonesian and Japanese languages, alongside Asian, Islamic and Contemporary Chinese Studies.

School of Culture and Communication – with programs in Art History, Arts and Cultural Management, Australian Indigenous Studies, Creative Writing, English and Theatre Studies, Media and Communications, Publishing and Editing, Journalism, and Screen and Cultural Studies.

School of Historical and Philosophical Studies – encompassing History, History and Philosophy of Science, Philosophy, Conservation and Classics and Archaeology.

School of Languages and Linguistics – includes French, German, Italian, Russian and Spanish languages, alongside European studies, Latin American studies and Linguistics, Applied Linguistics and English as a Second Language.

School of Social and Political Sciences – with programs in Anthropology and Development Studies, Criminology, Political Science, and Sociology and Social Policy.

Values and Behaviours

We are committed to benefiting the peoples, cultures and economies of Melbourne, Australia, the Region and the World. We expect all our staff to commit to our values of:

Rigour and Integrity, Generosity and Humility, Intellectual Freedom and Critical Independence,

Diversity and Inclusion, Trust and Mutual Respect,
Social Justice and Civic Responsibility

Courage and Creativity, Openness and Transparency,
Environmental Sustainability.

Position Description & Selection Criteria

Position No.	0049681
Classification	Level E
Salary	\$202,215 p.a.
Superannuation	Employer contribution of 17%
Working Hours	1 FTE Full-time
Basis of Employment	Continuing
Other Benefits	Click here

Position Summary

The School of Social and Political Sciences is at the forefront of teaching and research in the social sciences in Australia. The School has a team of dedicated academic and professional staff in the disciplines of Political Science, Criminology, Anthropology and Sociology as well as our allied research centres providing a dynamic and rewarding environment for staff and students.

The Professor in Criminology will bring internationally recognised expertise, outstanding research and scholarship, excellent leadership capabilities, exceptional engagement and outreach skills and enhance the teaching profile in the Master of Criminology and the Undergraduate Program. Their expert knowledge, networks and experience with grant success and publications would also enhance the profile of the Criminology discipline. The candidate's research field should complement or enhance the existing research strengths of Criminology at Melbourne.

The Professor in Criminology will be expected to make contributions in the areas of research, teaching, academic leadership and professional development.

The appointee will have an established research specialisation in an aspect of Criminology, and potential to achieve a high level of research performance through refereed publications and the securing of research grants. A principal duty of the

successful appointee will be to enhance the profile of the Criminology Discipline nationally and internationally, in research and engagement.

We welcome applications from Aboriginal and Torres Strait Islander peoples; and encourage applications from under-represented groups in the higher education sector.

FURTHER INFORMATION

- A Level E Academic will have attained recognition as an eminent authority in their discipline and achieved distinction at national and international levels
- All professors of the University are members of the Academic Board of the University.
- The webpage 'Joining Melbourne' provides prospective staff with useful information including an overview of the University, its strategy and direction, student and academic environments and with employment related information. <http://joining.unimelb.edu.au/>
- Candidates invited for interview should read the document 'University Expectations of a Professor' prior to interview: http://hr.unimelb.edu.au/data/assets/pdf_file/0006/517776/ExpectationsOfAProfessorv2.pdf

We welcome applications from Aboriginal and Torres Strait Islander people, people from different cultural backgrounds and people with disabilities.

Key Responsibilities

TEACHING

- ▶ Undertake curricula development and teaching into undergraduate and/or postgraduate programs
- ▶ Coordinate and teach undergraduate and postgraduate subjects and/or degree programs offered by the discipline
- ▶ Play a major role in the review and development of the discipline to ensure appropriate teaching programs to support research endeavors
- ▶ Contribute actively to postgraduate activities locally, nationally and internationally as well as supervise research higher degree students
- ▶ Contribute to and play a leadership role in raising the teaching profile of the discipline

RESEARCH

- ▶ Provide leadership and mentoring to staff of the program undertaking or considering research activities
- ▶ Network with other University departments and centres undertaking research
- ▶ Promote collaboration across institutions, nationally, and internationally as required to further relevant research
- ▶ Actively participate in research seminars and conferences
- ▶ Manage a balanced research budget
- ▶ Applying for research grants per the Faculty guidelines
- ▶ The conduct of research leading to high quality publications in leading internationally refereed journals in line with Faculty minimum expectations

LEADERSHIP, COMMUNITY SERVICE AND ENGAGEMENT

Professors at the University have a unique opportunity to profess their discipline in the public arena and to ensure the community is well informed on key issues affecting it. The Professor of Criminology is expected to have strong community linkages, having communications through the press, support groups, peer meetings and interactions with industry.

- ▶ Contribute to leadership in Criminology, the School and the University (e.g., as Discipline Chair, convenor of a degree program or other formal and informal leadership roles)
- ▶ Mentor and supervise the performance of colleagues
- ▶ Engagement and cultivation of close links with key stakeholders
- ▶ Involvement in professional activity, including participation in meetings of professional societies
- ▶ Development of strong links with government and non-government organisations locally and abroad

Selection Criteria

ESSENTIAL

- ▶ A completed PhD in Criminology or related discipline

- ▶ An internationally recognised publication record of distinction and innovation and recognised excellence in their research field
- ▶ Demonstrated track record of success in gaining nationally and/or internationally competitive research grants
- ▶ Extensive knowledge of the sector and demonstrated ability to collaborate with industry partners to deliver collaborative engagement programmes
- ▶ Demonstrated capacity to develop and foster new engagement activities, including creativity in engagement with the public and or industry
- ▶ Demonstrated ability to work independently as well as work in a team
- ▶ Demonstrated capacity to mentor staff and provide service
- ▶ Demonstrated excellence in teaching including in the development of new subjects
- ▶ Demonstrated excellence in leadership and management including the capacity to contribute to and create strategic planning that will advance the discipline
- ▶ Demonstrated ability to supervise honours and graduate level research theses, and to participate in supervisory panels at the graduate research level.
- ▶ Demonstrated capacity to contribute to the collegial environment and intellectual culture of the School of Social and Political Sciences, including the ability to interact positively with academic and administrative staff.
- ▶ Commitment to the Faculty's Values and Behaviours outlined on page 6.

DESIRABLE

- ▶ Strong record of public engagement in areas of Criminological importance

Special Requirements

- Employment in this position is conditional upon the adhering to the University's "fit and proper" checks where required and receipt of a valid Working with Children Check prior to commencement.

Equal Opportunity, Diversity & Inclusion

The University is an equal opportunity employer and is committed to providing a workplace free from all forms of unlawful discrimination, harassment, bullying, vilification and victimisation. The University makes decisions on employment, promotion and reward on the basis of merit.

The University is committed to all aspects of equal opportunity, diversity and inclusion in the workplace and to providing all staff, students, contractors, honorary appointees, volunteers and visitors with a safe, respectful and rewarding environment free from all forms of unlawful discrimination, harassment, vilification and victimisation. This commitment is set out in the University's People Strategy 2015-2020 and policies that address diversity and inclusion, equal employment opportunity, discrimination, sexual harassment, bullying and appropriate workplace behaviour. All staff are required to comply with all University policies.

The University values diversity because we recognise that the differences in our people's age, race, ethnicity, culture, gender, nationality, sexual orientation, physical ability and background bring richness to our work environment. Consequently, the People Strategy sets out the strategic aim to drive diversity and inclusion across the University to create an environment where the compounding benefits of a diverse workforce are recognised as vital in our continuous desire to strive for excellence and reach the targets of Growing Esteem.

Occupational Health & Safety (OHS)

All staff are required to take reasonable care for their own health and safety and that of other personnel who may be affected by their conduct.

OHS responsibilities applicable to positions are published at:

<http://safety.unimelb.edu.au/people/community/responsibilities-of-personnel>

These include general staff responsibilities and those additional responsibilities that apply for Managers and Supervisors and other Personnel.

Organisation Unit

<http://ssps.unimelb.edu.au/>

Budget Unit

arts.unimelb.edu.au

The Faculty of Arts is at the forefront of teaching and research in the languages, humanities and social sciences fields in Australia and in many cases internationally. Founded in 1853, it is one of Australia's oldest and largest faculties with approximately 450+ staff and 10,000+ students across undergraduate and graduate programs – engaged in over 900 subjects in more than 40 areas of study. Over 600 international students from more than 50 different countries representing five continents are currently studying towards degrees offered in the Faculty.

The Faculty of Arts maintains strong connections with leading international universities through research collaborations and student exchange programs, and nurtures relationships with government, not-for-profit and private organisations through student internship placements, research projects and community engagement.

As well as housing the Graduate School of Humanities and Social Sciences, the Faculty of Arts also comprises five academic schools:

- Asia Institute
- School of Culture & Communication
- School of Historical & Philosophical Studies
- School of Languages & Linguistics
- School of Social & Political Sciences

Our students and staff are supported by business units within the Faculty including

- The Office of the Dean & Faculty Executive Director
- The Academic Support Office
- The Strategy, Planning & Resources Unit
- The External Relations Unit
- The Research Office
- The Human Resource Office

The University of Melbourne

Established in 1853, the University of Melbourne is a leading international university with a tradition of excellence in teaching and research. The main campus in Parkville is recognised as the hub of Australia's premier knowledge precinct comprising eight hospitals, many leading research institutes and a wide-range of knowledge-based industries. With outstanding performance in international rankings,

the University is at the forefront of higher education in the Asia-Pacific region and the world.

The University employs people of outstanding calibre and offers a unique environment where staff are valued and rewarded.

Further information about working at The University of Melbourne is available at <http://about.unimelb.edu.au/careers>.

Growing Esteem, The Melbourne Curriculum and research at Melbourne: Ensuring Excellence and Impact to 2025

Growing Esteem describes Melbourne's strategy to achieve its aspiration to be a public-spirited and internationally - engaged institution, highly regarded for making distinctive contributions to society in research and research training, learning and teaching, and engagement.

<http://about.unimelb.edu.au/strategy-and-leadership>

The University is at the forefront of Australia's changing higher education system and offers a distinctive model of education known collectively as the Melbourne Curriculum. The new educational model, designed for an outstanding experience for all students, is based on six broad undergraduate programs followed by a graduate professional degree, research higher degree or entry directly into employment. The emphasis on academic breadth as well as disciplinary depth in the new degrees ensures that graduates will have the capacity to succeed in a world where knowledge boundaries are shifting and reforming to create new frontiers and challenges. In moving to the new model, the University is also aligning itself with the best of emerging European and Asian practice and well-established North American traditions.

The University's global aspirations seek to make significant contributions to major social, economic and environmental challenges. Accordingly, the University's research strategy Research at Melbourne: Ensuring Excellence and Impact to 2025 aspires to a significant advancement in the excellence and impact of its research outputs.

<http://research.unimelb.edu.au/our-research/research-at-melbourne>

The strategy recognises that as a public-spirited, research-intensive institution of the future, the University must strive to make a tangible impact in

Australia and the world, working across disciplinary and sectoral boundaries and building deeper and more substantive engagement with industry, collaborators and partners. While cultivating the fundamental enabling disciplines through investigator-driven research, the University has adopted three grand challenges aspiring to solve some of the most difficult problems facing our world in the next century. These Grand Challenges include:

- Understanding our place and purpose – The place and purpose grand challenge centres on understanding all aspects of our national identity, with a focus on Australia's 'place' in the Asia-Pacific region and the world, and on our 'purpose' or mission to improve all dimensions of the human condition through our research.
- Fostering health and wellbeing – The health and wellbeing grand challenge focuses on building the scale and breadth of our capabilities in population and global health; on harnessing our contribution to the 'convergence revolution' of biomedical and health research, bringing together the life sciences, engineering and the physical sciences; and on addressing the physical, mental and social aspects of wellbeing by looking beyond the traditional boundaries of biomedicine.
- Supporting sustainability and resilience – The sustainability and resilience grand challenge addresses the critical issues of climate change, water and food security, sustainable energy and designing resilient cities and regions. In addition to the technical aspects, this grand challenge considers the physical and social functioning of cities, connecting physical phenomena with lessons from our past, and the implications of the technical solutions for economies, living patterns and behaviours.

Essential to tackling these challenges, an outstanding faculty, high performing students, wide collaboration including internationally and deep partnerships with external parties form central components of Research at Melbourne: Ensuring Excellence and Impact to 2025.

Governance

The Vice Chancellor is the Chief Executive Officer of the University and responsible to Council for the good management of the University.

Comprehensive information about the University of Melbourne and its governance structure is available at <http://www.unimelb.edu.au/governance>



- Engaging in an active and vibrant campus life
- A focus on health and wellbeing
- Outstanding staff benefits in addition to competitive salary packages

Staff benefits on offer at the University include the opportunity to salary package everything from childcare and additional superannuation to subscriptions to the Melbourne Theatre Company. Benefits can be tailored to best suit individual needs and circumstances, including generous relocation support.

Course fees can also be salary packaged and come at a 25% discount for staff and their immediate families. Unsurprisingly, the University has high numbers of women returning to work. It was one of the first winners of the Fair and Flexible Employer Recognition award.

People and Benefits

The University is committed to providing an intellectually stimulating and personally rewarding workplace which attracts people who are the best in their professional, academic and teaching fields



Outstanding academic staff are at the heart of the University's teaching, research and engagement endeavours. The University is proud of its many staff that have been recognised through prestigious national and international awards and through membership of Australia's learned academics. Among the many scholars of international renown at the University is the winner of the Nobel Prize – Professor Peter Doherty (Physiology and Medicine) and many other public intellectuals and scientific leaders.

The Benefits

The University offers staff more than just a job – it offers them an opportunity to be part of a dynamic world class organisation which provides its staff with exceptional benefits and support at every stage of their life and career.

- Working in a culturally inclusive environment



Living and Working in Melbourne

Geography

Melbourne is the capital city of Victoria and the second largest city in Australia. It is set around the shores of Port Phillip Bay and sits beside the Yarra River, around five kilometres from the bay.

Melbourne is home 4.5 million people and a metropolitan area of 9990.5 km². The Economist Intelligence Unit has rated Melbourne one of the world's most liveable city for six consecutive years, based on its education, entertainment, health care, research and development, tourism and sport.

The City of Melbourne municipality, in which the University's main Parkville campus is based, covers 37.7 km² and has a population of more than 143 000 people. It includes the city centre and a number of attractive inner suburbs with thriving communities and businesses.

The City of Melbourne is home to residents from 180 countries who speak more than 233 languages and dialects and follow 116 religious faiths. The Wurundjeri, Boonwurrung, Taungurong, Dja Dja Wurrung and the Wathaurung people of the Kulin Nation are the Traditional Owners of the land now known by its European name of Melbourne.

The City of Melbourne is recognised as Australia's cultural capital with a number of world-class galleries and museums, internationally renowned food and wine regions, and an impressive year-round calendar of events catering for all tastes. Melbourne has many precincts, each with its own unique character and offering different cultural experiences, for example Greek culture around Lonsdale Street, Italian on Lygon Street Carlton, Chinese in Chinatown and French on Collins Street.

Parkville Campus

Parkville is the main campus of the University of Melbourne. It stretches across more than 20 hectares and is located just 1.7 kilometres north of the city centre. The campus is well connected by trams and buses and a short walk to Melbourne Central Station with frequent buses to North Melbourne Station. Plans to build an underground train line connecting North Melbourne to South Yarra, via the University and the Central Business District, have been approved with the construction to begin in 2018.

Other major University of Melbourne buildings are located off campus, east of Swanston Street and south of Grattan Street as far as Queensberry Street.

The University has 12 residential halls and colleges, most of which line the northern boundary of the campus along College Crescent.

The Parkville campus environment is vibrant and dynamic where music, exhibitions, sporting facilities, libraries and excellent cafes can be found for all to enjoy. Numerous services are located on the Parkville campus for convenience.

There are multiple green spaces on campus as well as large public spaces located close by, including Royal Park and the Carlton Gardens.

The University of Melbourne is constantly expanding and improving its facilities to ensure that staff and students are working within world-class environments, and with top-quality resources.



In an ongoing partnership with its neighbour, the Royal Melbourne Hospital, the University of Melbourne established the Melbourne Biomedical Precinct, a major global research and teaching powerhouse with 25 health service, research and academic partners sharing a formidable history of ground-breaking medical discoveries and developments. Partners within the Precinct include Walter and Eliza Hall Institute, Biomedical Research Victoria and CSL Ltd, all within a three-kilometre radius, allowing them to share resources and engage in meaningful collaborations.

The University of Melbourne is also at the heart of a key initiative supporting the Victorian Government's Defence Technologies Sector Strategy to develop an advanced manufacturing and research precinct. In 2016 the Victorian Government acquired a 37-hectare site at Fishermans Bend with the aim of creating a world-class design, engineering and technology precinct. The technology hub will become a centre of excellence attracting cutting-edge innovators in the areas of aerospace, defence, marine design and automotive design.

Recently, the University of Melbourne also opened a new building for the Melbourne School of Design, designed in collaboration with John Wardle Architects (Melbourne) and NASAAA (Boston). Retaining the original façade, the remainder of the building was completely reimaged and purpose built, providing integrated functional space for class workshops, private and group study and discussion pods. The building features architectural features and construction methods inspiring students and encouraging them to continue their learning outside of the classroom.

Another recently completed project is the Arts West Building. Opened in 2016 by the Faculty of Arts, it is a showcase of innovative learning spaces that support new ways of teaching and learning.

The Carlton Connect Initiative was recently launched and will build an innovative community precinct which draws on local talent and business to tackle complex problems. Working across sectors, the Initiative drives partnerships – connecting world-class talent with 21st century technologies to address global challenges that cannot be solved by one sector alone.



Further Information

General Information about the University of Melbourne is available at its website www.unimelb.edu.au

About the University of Melbourne
about.unimelb.edu.au

The University of Melbourne's Strategic Plan 2015 – 2020

Growing Esteem

growingesteem.unimelb.edu.au

2018 Annual Report

https://petercook.unimelb.edu.au/__data/assets/pdf_file/0003/3045171/2018-PeterCook_AnnualReport.pdf

Faculty of Arts

arts.unimelb.edu.au

Research

University of Melbourne research strategy and implementation

research.unimelb.edu.au

Teaching

Teaching and Learning at the University of Melbourne

provost.unimelb.edu.au

Engagement

University of Melbourne Engagement strategy

[about.unimelb.edu.au/strategy-and-](http://about.unimelb.edu.au/strategy-and-leadership/engagement)

[leadership/engagement](http://about.unimelb.edu.au/strategy-and-leadership/engagement)

Careers

<https://about.unimelb.edu.au/careers>



The Faculty of Arts promotes a workplace that actively seeks to include, welcome and value unique contributions of all people. People from Indigenous, culturally & linguistically diverse backgrounds and people with disabilities are encouraged to apply, and if seeking support in submitting an application are welcomed to contact the Faculty by emailing their contact details and position number to arts-hr@unimelb.edu.au

How to Apply

Please submit your application via the below link <http://about.unimelb.edu.au/careers>, select the relevant option ('Current Staff' or 'Prospective Staff'), then find the position by title or number.

Enquiries

Contact for enquiries only, please do not send our application to this contact

Name	Professor Karen Farquharson
Email	karen.farquharson@unimelb.edu.au